

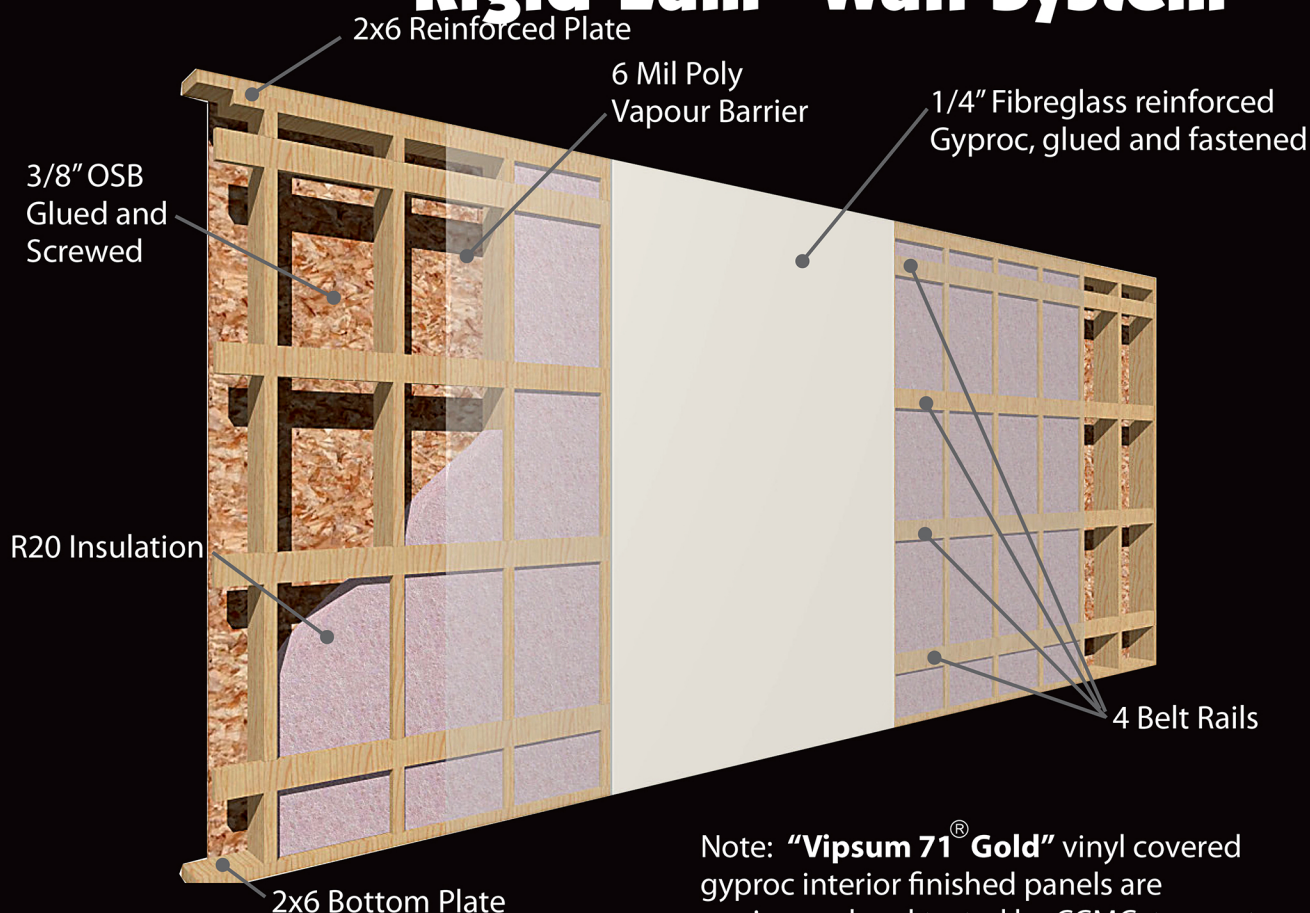

The Strongest Wall

"Rigid-Lam" Wall System



Note: **"Vipsum 71[®] Gold"** vinyl covered gyproc interior finished panels are engineered and tested by CCMC to meet or exceed the strength and durability offered in conventional 1/2" drywall while decreasing the weight. This means a stronger and more durable home for you.

Regent Homes now offers the new and improved Rigid-Lam wall structure on all of their housing products. This unique system further improves the overall strength of the home making it the most superior structure in the industry today. A strong wall means better transportation, improved longevity and better resale value.

See your retailer for further details.

